

70

ESSENTIAL SERIES

FR033U

FRIDGE-FREEZER

OFFICINE GULLO
DESIGN

FRIDGE-FREEZER



DESCRIPTION

The built-in fridge-freezer combination offers stainless steel interior, Generous LED lighting concept, Solid aluminum door bins, Net volume 16.2 cu.ft. Integrated automatic ice maker with fixed water connection, One motorized glass shelf, adjustable when fully loaded, Fully extendable freezer drawer with practical divider. Electronic precision temperature control with digital temperature display. Dynamic cool air distribution with Multi- Flow Air System. Automatic defrosting with defrost water evaporation. Activated charcoal air filter. Energy-saving vacation mode. Open-door and malfunction warning system. ENERGY STAR® qualified. Gaggenau mechanism.

FEATURES

Cooling compartment: Net volume 11 cu. ft. No-frost technology with fast cooling. Temperature adjustable from 35 °F to 46 °F (+2 °C to +8 °C). 3 safety glass shelves, 1 of which is motorized. 1 fully extendable drawer with transparent front. Bright interior lighting with LED sidewall pillars. 2 height adjustable door bins, one large gallon door bin. 1 door bin with transparent front flap. Temperature controlled drawer: Net volume 0.7 cu. ft. No-frost technology. 1 continuous, fully-extendable temperature controlled drawer with transparent front and integrated lighting. Freezer compartment: Net volume 4.9 cu. ft. (138 liters). No-frost technology with fast freezing. Temperature adjustable from 7 °F to -9°F (-14 °C to -25 °C). 2 fully extendable drawers. Interior lighting with 1 spot. Ice dispenser: Integrated automatic ice maker in the freezer compartment, with fixed water connection. Ice maker can be switched off independently. Ice cube production approx. 3.5 lb (1.7 kg)/24 h. Removable ice storage bin with approx. 6.6 lb (3 kg) capacity.

INSTALLATION

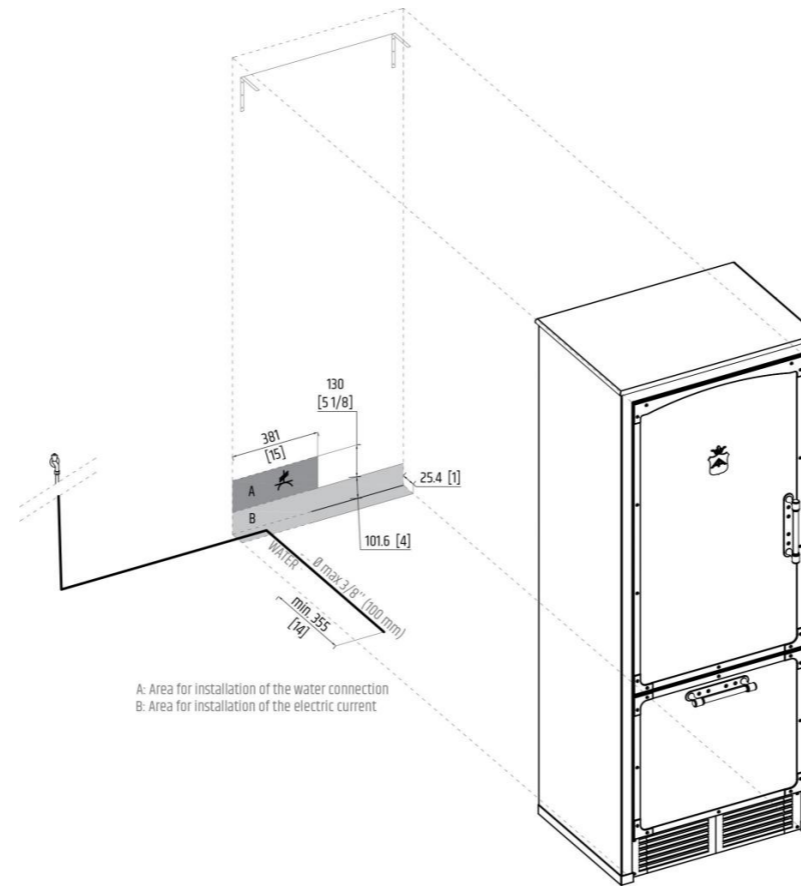

PLANNING NOTES

Flat hinge. Door hinge right, reversible. Door opening angle of 115°, optional 90° door stop. Max. door panel weight: Door 77 lb. Drawer 22 lb. Shut-off valve for water connection must be planned next to the appliance and always be accessible. If the water pressure exceeds 116 psi, connect pressure relief valve between water tap and hose set. Cold water connection required. Electrical location 6" above ground in lower left corner of unit. Water pressure 29 to 116 psi.

TECHNICAL DRAWINGS AND CONNECTIONS

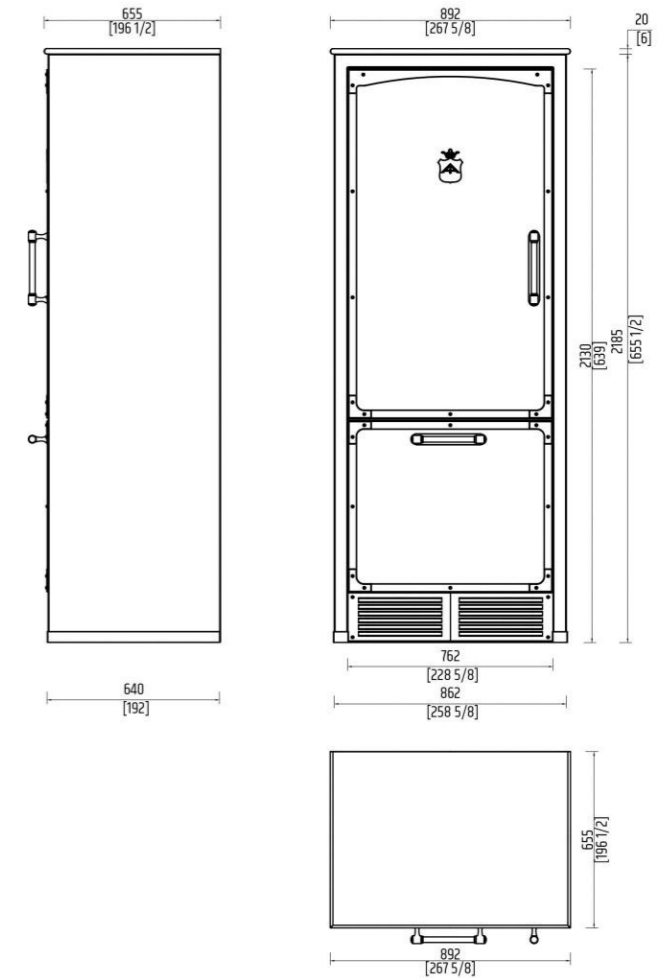

TECHNICAL INFO

WIDTH	33 15/16" in
DEPTH	25 3/6" in
HEIGHT	86" in
VOLTAGE	[120 V]
FREQUENCY	Hz: 60
WATER INLET SUPPLY HOSE	Supply hose 118" with 3/4" connection
WATER PRESSURE	29 to 116 psi
PLUG TYPE	wired with plug.
NOISE LEVEL	43
REFRIGERATOR NET CAPACITY	11 cu. ft.
FREEZER NET CAPACITY	4.9 cu. ft.
REVERSIBLE DOOR	X